



Multi door



Free standing



Floor standing

Large ground mounted enclosure enhancements

Quality • Performance • Aesthetics

With expanded capabilities in our Sherman, Texas facility, innovative modification solutions and enhanced design features, the B-Line series large enclosures provide high quality solutions to help protect your electrical systems across a broad range of environments.

Our enclosures provide reliable electrical equipment protection for variable frequency drives, motors, controls, electrical devices and other power distribution equipment.

Expanded Solutions

- Broad range of standard, modified and custom NEMA 12, 4 and 4X enclosures
- Sizes range from 54"Hx24"Wx8"D to 90"Hx198"Wx36"D
- Single, double and multi-door options
- Floor- and free-standing ground mount options
- Welded body and disconnect options
- Multiple finish options
- Extensive range of modification services available
- Full line of accessories: thermal management, panels, locks, latches, lights, and many others
- UL Listed for U.S. and Canada to UL508 and CSA C22.2 standards.

Reliable, Quality Solutions

- ISO 9001:2008 certified facility

New Capabilities and Features

- New state-of-the-art finishing equipment and welding processes offers greatly enhanced painted and stainless steel finishes
- Concealed hinges and larger beveled doors offer modern aesthetics while providing door removability and interchangeability
- A new robust handle design provides smooth operation and a superior door seal
- Use of seamless foam-in-place gaskets assures high performance seal
- Larger body opening provides easier access for panel installation and equipment mounting

Our B-Line series enclosure specialists are ready to assist you with your next order.

- Enclosure Sales Managers
- Enclosure Quote Specialists
- Engineering Design Specialists

EATON

Powering Business Worldwide

Reference ENC-17 product catalog for sizes, models, ratings, accessories, materials, finishes and additional services available, or visit Eaton.com/enc

Contact us at 800-851-7415

Quality • Performance • Aesthetics

Large enclosures you want when you need them

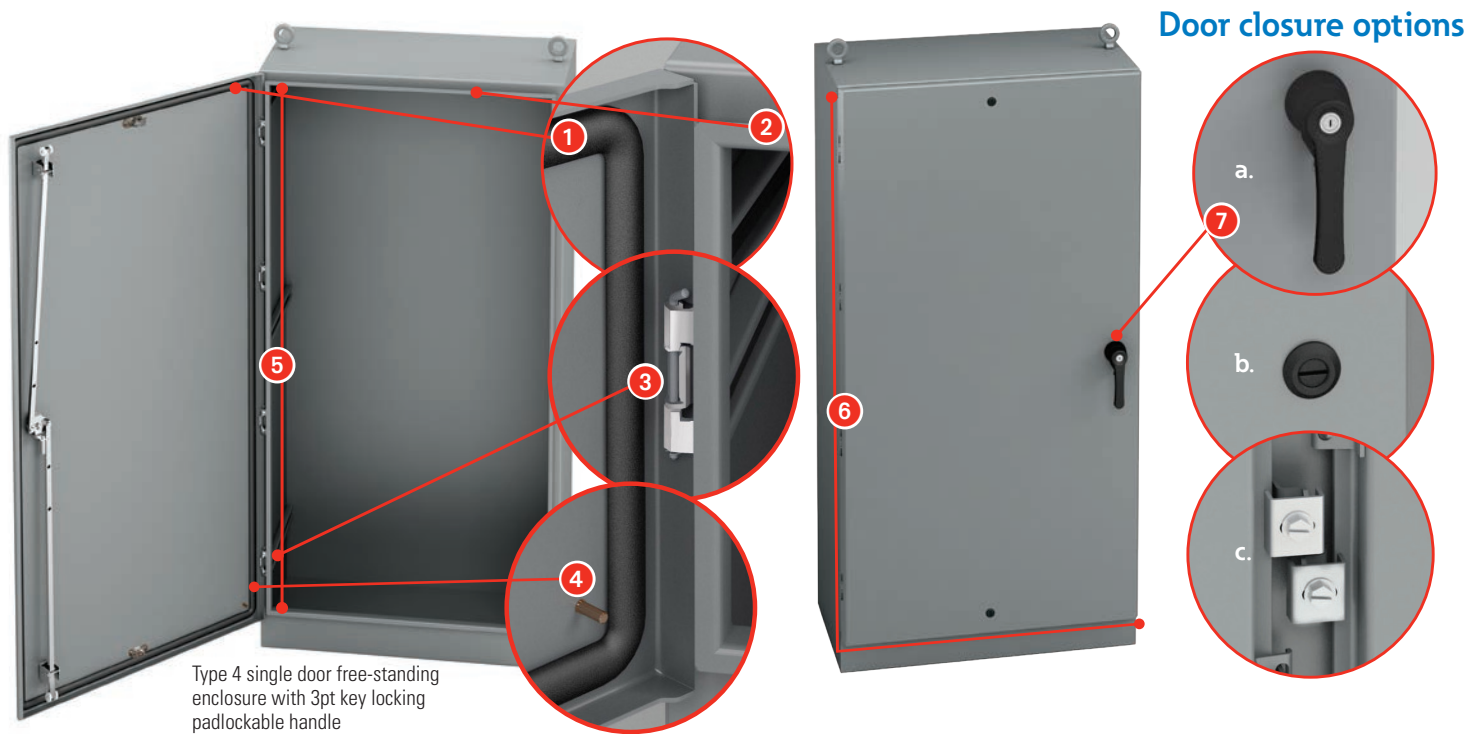

Type 4 single door free-standing enclosure with 3pt key locking padlockable handle

Manufactured and stocked in Sherman, Texas

- 1 Robotically applied seamless foam-in-place gasket helps assure a high performance seal in tough environmental conditions
- 2 Return flange trough collar on all sides diverts liquids to enhance performance
- 3 Concealed hinges provide removable and interchangeable doors
- 4 Ground provisions provided on all doors, bodies and back panels with hardware for effective equipment grounding
- 5 Larger body opening improves panel and equipment installation
- 6 Concealed hinges and larger beveled doors help provide improved modern aesthetics while minimizing surfaces that can trap dirt and other debris
- 7 Multiple door closure options include
 - a. 3-point key locking/padlockable handle
 - b. Quarter-turn latch
 - c. Door clamp

Standard material and finish options

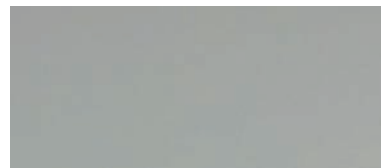

Carbon steel with an ANSI 61 Gray smooth powder-coated finish



304 & 316L Stainless Steel with a smooth #4 brushed finish on external surfaces and clean internal surfaces free of weld residues and other debris

Modification services



Modification capabilities to provide special sizes, painted finishes, added holes and cut-outs, pre-installed accessories, and much more.

For modified support or quotation form, visit Eaton.com/modified

Contact us at EnclosuresTeam@Eaton.com

Reference modified capabilities flyer MODENC and special paint flyer ENCPAINT.



Eaton
1000 Eaton Boulevard
Cleveland, OH 44122
United States
Eaton.com

© 2019 Eaton
All Rights Reserved
Printed in USA
Publication No. SA304001EN
September 2019 LRGENC-19

B-Line Division
509 West Monroe Street
Highland, IL 62249
United States
Phone: 800-851-7415
Eaton.com/enc

Eaton is a registered trademark.
All other trademarks are property of their respective owners.

Follow us on social media to get the latest product and support information.

