

SPECIFICATIONS

Modular Jack

Mechanical

Mating Force: 5Pounds max.
Unmating Force: 10Pounds max.
Durability: 1000 Cycles

Electrical

Voltage Rating: 125VAC
Current Rating: 1.5A max.
Contact Resistance: 30mΩ max.
Dielectric Withstanding Voltage: 1500VDC
Insulation Resistance: 500MΩ min.

Physical

Housing: High Temp. Thermoplastic, UL 94V-0 Molded Black
Contact: Phosphor Bronze
Shell: Brass Alloy
Operating Temperature: 0°C to +70°C

JFM Series
RJ45 1X1
R/A T/H Type
1.27mm [.050"] Pitch
10/1000 Base-T

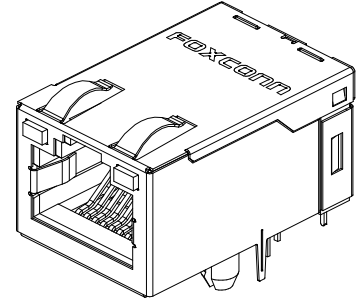

DRAWING

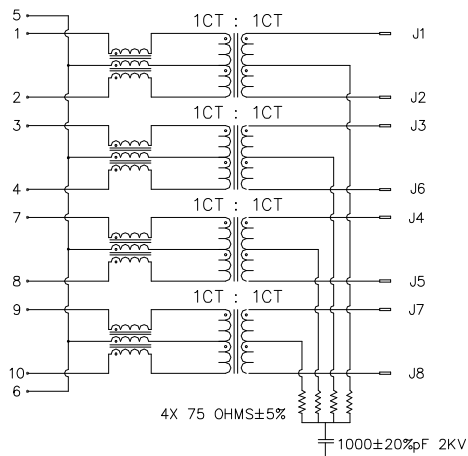
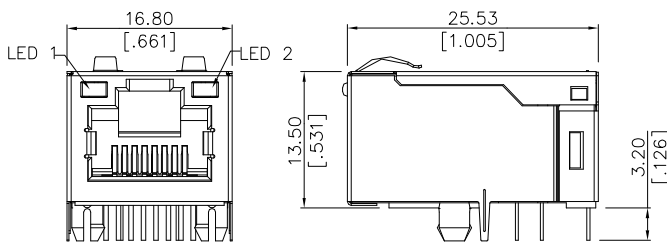

SCHEMATIC

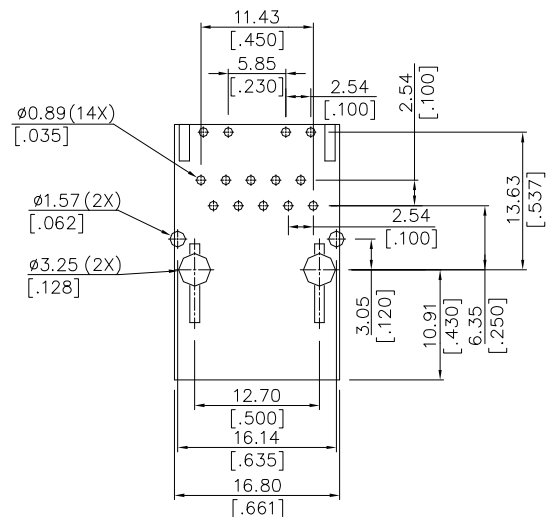

RECOMMENDED P.C.B. LAYOUT

ORDERING INFORMATION

PRODUCT NO.: JFM 3 8 1 1 * - 2101 - 4 F

Series Prefix:
JFM=RJ With Magnetic

Protocol Type:
3=10/1000 Base T

Core Count:
8=8 Core

Configuration:
1=1X1

Lead Free Code:
F= Lead Free

Package type:
4=Soft Tray

Extension Code:

Leds
See Table

PCB Attach Method:
1=Solder Tail

P / N	Left Side	Right Side
JFM38111-2101-4F	YELLOW LED	GREEN LED
JFM3811F-2101-4F	GREEN LED	ORANGE / GREEN LED